



INSTALLATION INSTRUCTIONS

Accessory
SIDE SPOILERS
P/N 08F04-SZT-1T0

Application
2014 CR-Z

Publications No.
All 50506

Issue Date
SEP 2013

PARTS LIST

Left side under spoiler



Right side under spoiler



10 Screws



18 Seals

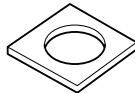

TOOL AND SUPPLIES REQUIRED

Phillips screwdriver

Utility knife

Trim Tool Set (SOJATP2014)

(Available through the Honda Tool and Equipment program. On the iN, click on: Service/Service Bay/Tool and Equipment Program, then enter the number under "[Search](#)." Or call 888-424-6857.)

Pushpin

Drill

3 mm and 6 mm Drill bits

File

Eye protection (safety goggles, face shield, etc.)

Masking tape

Isopropyl alcohol

Shop towel

Tape measure

Blanket

Illustration of the Side Spoilers on the Vehicle

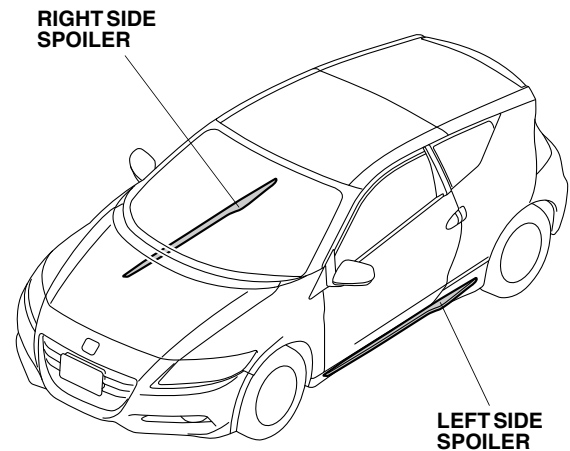

INSTALLATION

Customer Information: The information in this installation instruction is intended for use only by skilled technicians who have the proper tools, equipment, and training to correctly and safely add equipment to your vehicle. These procedures should not be attempted by "do-it-yourselfers."

NOTE:

- Do not damage the paint finish.
- This kit should be installed only if the ambient air temperature is 15°C (60°F) or above.
- To allow the adhesive to cure, do not wash the vehicle for 24 hours. Please advise the customer.

1. Remove five clips from the bottom of the driver's side sill trim.

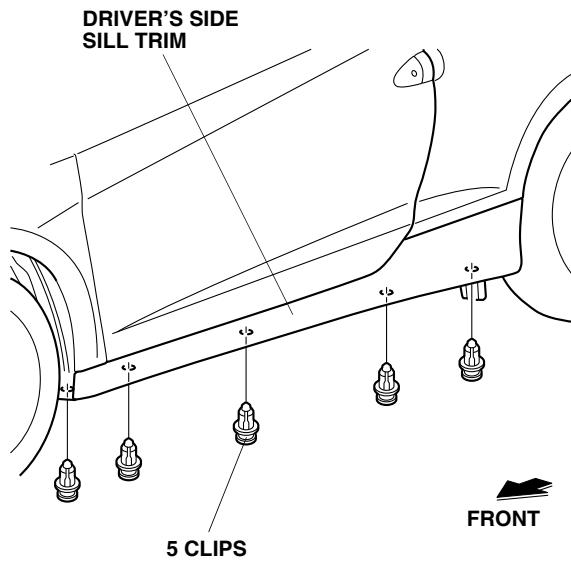

2. Remove the driver's side sill trim (nine clips). **NOTE:** Place the driver's side sill trim on a blanket after removal.

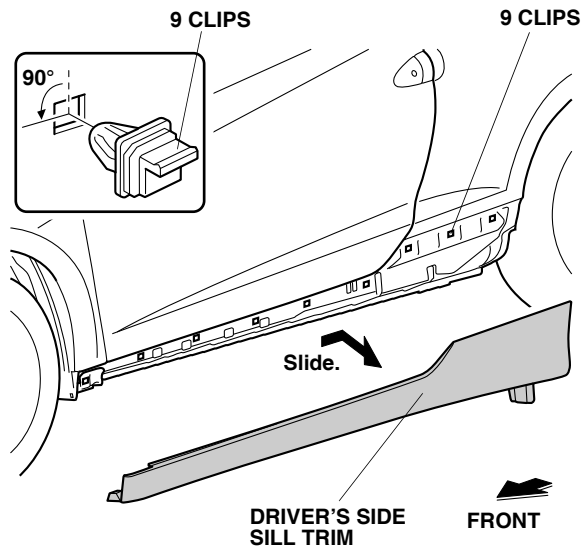

3. Remove the nine clips from the side sill trim by turning each clip 90° to remove.

Installing the Side Under Spoiler

4. Using a pushpin, pierce the five scribe marks on the driver's side sill trim.

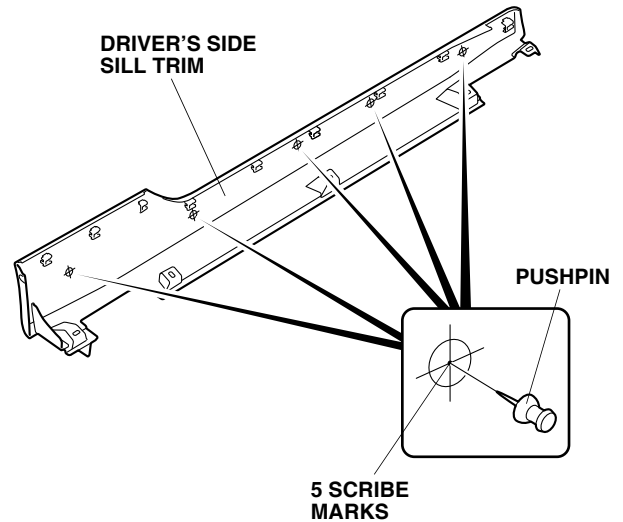

5. While wearing eye protection, drill the five holes made in the driver's side sill trim with a 3 mm drill bit, then finish with a 6 mm drill bit. Remove any burrs.

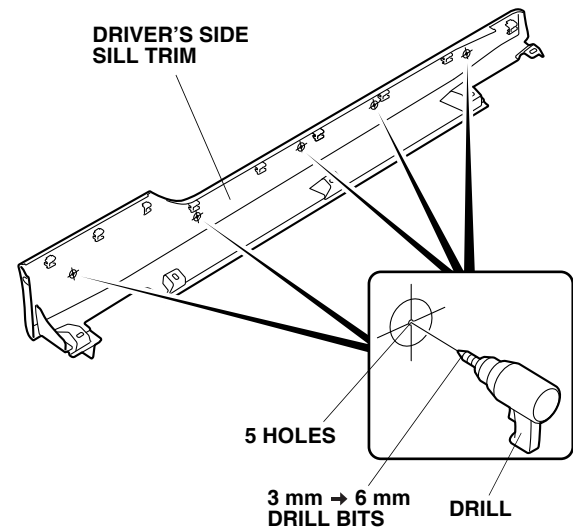

- Using isopropyl alcohol on a shop towel, thoroughly clean the side sill trim where the side spoiler will attach.

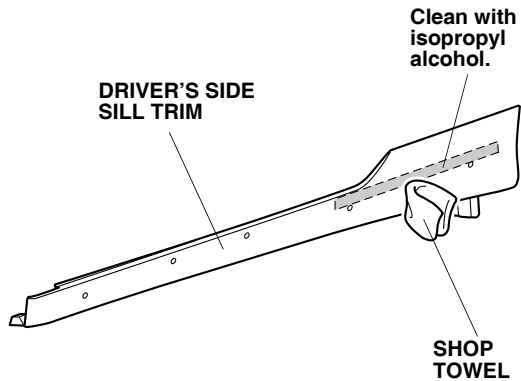

- Using a utility knife, slit the adhesive backing on the left side spoiler at the location shown.

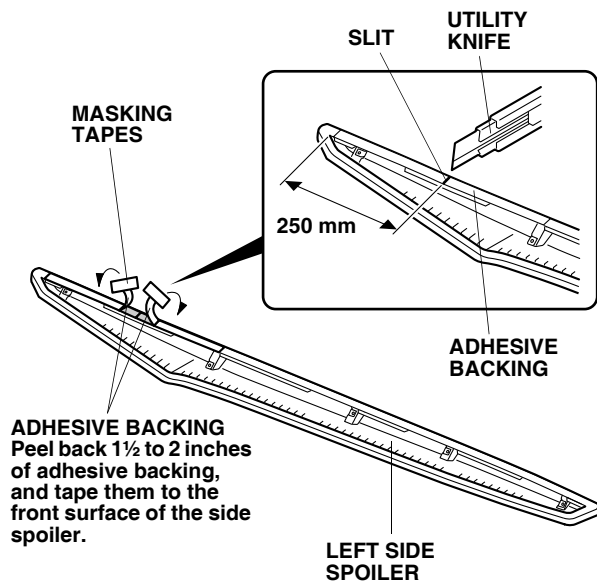

- Peel back approximately 1½ to 2 inches of adhesive backing from each adhesive tape, and tape the ends to the front surface of the side spoiler.

- Loosely install the left side spoiler to the driver's side sill trim with five screws in this order **1** → **2** → **3** → **4** → **5**.

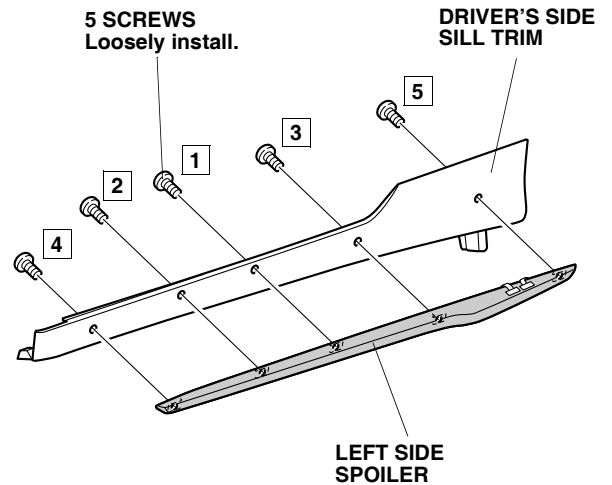

- Tighten the middle screw **1** loosely installed in step 9.
NOTE: Do not over-tighten the screw.
- While applying light pressure against the left side spoiler, carefully remove the adhesive backings.

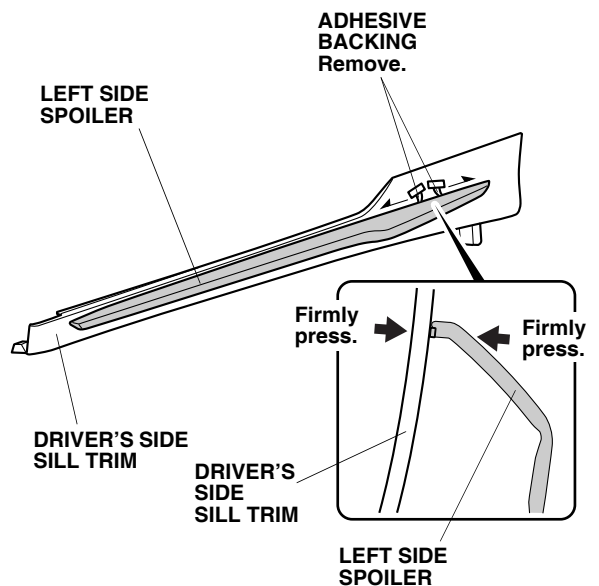

- Using the palm of your hand, firmly press the left side under spoiler to the driver's side sill trim in the areas shown.
- Tighten the remaining four screws loosely installed in step 9 in this order **2** → **3** → **4** → **5**.
NOTE: Do not over-tighten the screws.

14. Remove and discard the nine old seals from the nine clips removed in step 3.

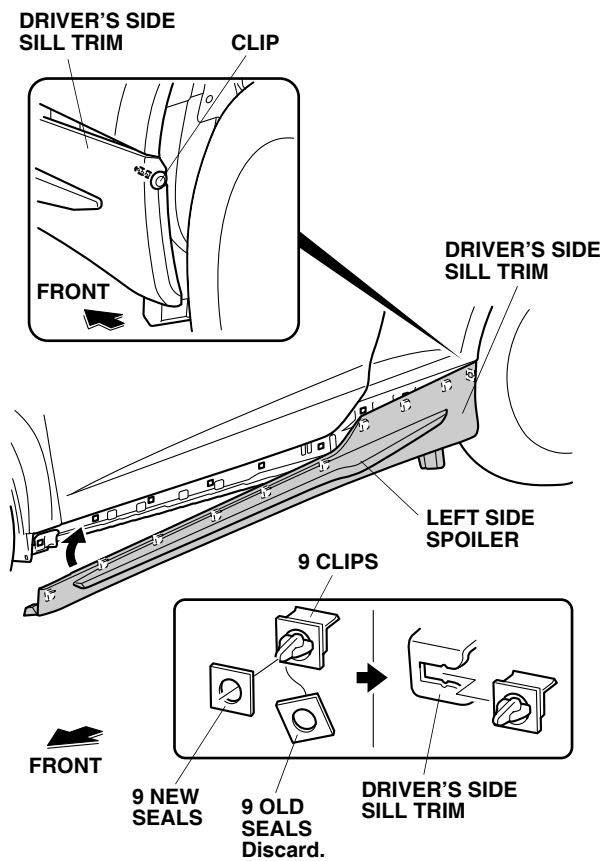

15. Install nine new seals onto the nine clips and install the nine clips onto the driver's side sill trim.
16. Secure the one clip on the rear side of the driver's side sill trim to the vehicle, then swing the driver's side sill trim into position and install the nine clips.
17. Reinstall all removed parts.
18. Repeat steps 1 through 17 to install the right side spoiler on the right side of the vehicle.

USE AND CARE

Please copy this page and hand it to the customer.

The side spoiler has a textured surface. To prevent wax build-up on the textured surface, do not wax the side under spoiler. To clean the textured surface, use a soft brush to remove any debris.